

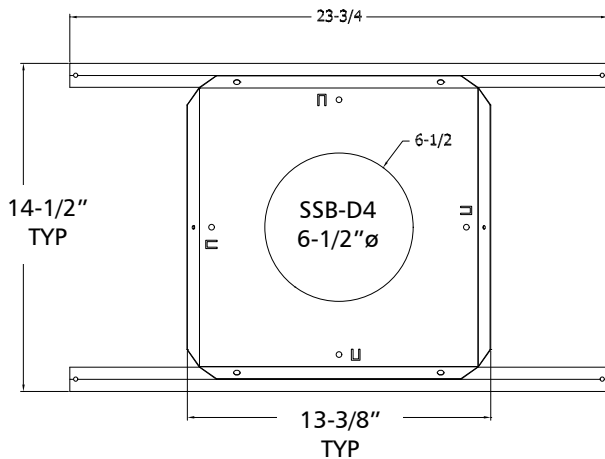

SSB-D4
SSB-D6
SSB-D8

**Loudspeaker Mounting Device
 For "Dog-Leg" Mount**

0402 - LOUDSPEAKER MOUNTING DEVICES



SSB-D6 Shown

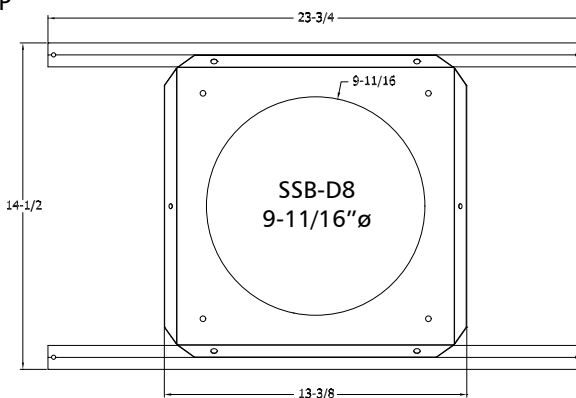
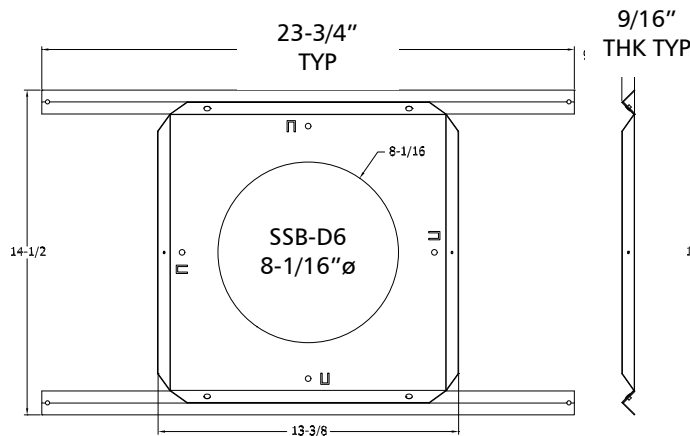

GENERAL DESCRIPTION

The Quam SSB-Dx is a rust resistant steel, load bearing support for most loudspeakers using a "dog-leg" or cam type mounting mechanism designed for suspended ceilings.

INTENDED USE

Parallel to floor plane in a suspended ceiling structure; maximum span of 24" in one dimension; indoor environment.

Models shown correspond to nominal driver size; viz: SSB-D4 is used with a nominal 4" (100mm) driver.

RECOMMENDED ADDITIONAL QUAM COMPONENTS

For acoustical isolation and loudspeaker protection when loudspeaker assembly does not have an integral back-can.

SSB-D4, SSB-D6	QUAM ERD8U, 3-1/2" D
SSB-D8	QUAM ES8-6, 6" D

IMPORTANT NOTE!

Contractors are urged to verify enclosure diameter and height of loudspeaker above loudspeaker support deck prior to ordering support or rear enclosure, if required.

Recommended construction sequences, installation instructions and A&E Specifications are available in various formats on the Quam Architects' and Engineers' Resources CD or on the web at: www.quamspeakers.com

04 BACK BOXES / MOUNTING DEVICES

Quam-Nichols Company

234 East Marquette Road, Chicago, IL 60637
 Phone: (800) NEED NOW Fax: (888) NEED NOW
 (800) 633 - 3669 (888) 633 - 3669
 E-Mail: neednow@qnc.com www.quamspeakers.com

