

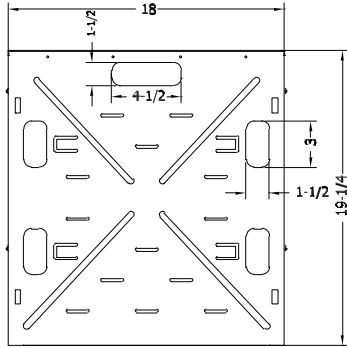

Quam

AS19X16/COVER Wall Mount Equipment Shelf And lockable Cover Combination, Black AS19X16/COVER/ W Wall Mount Equipment Shelf

0701 - WALL MOUNT EQUIPMENT SHELVES



AS19X16/COVER Shown

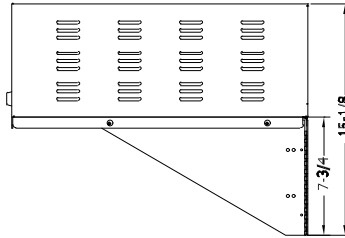
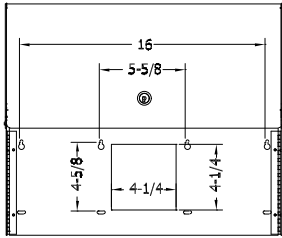

GENERAL DESCRIPTION

The Quam AS19X16/COVER/x is a steel, wall mounted equipment shelf assembly consisting of a horizontal perforated platform with "X frame" reinforcement ribs and 1/2" raised front lip, two support arms and perforated steel removable equipment cover with lock and key assembly. Finish: Baked epoxy hybrid.

FINISH OPTIONS

Black Order as: AS19x16
White Order as: AS19X16/ W

INTENDED USE

Indoor, mounted perpendicular to wall surface and parallel to floor. Tamper resistant applications only; does not protect from water, dust or foreign objects. Static load as noted in specifications.

SPECIFICATIONS

Static Load Capacity	AS19X16/COVER - 40 pounds*
----------------------	----------------------------

*SAFETY WARNING! It is the responsibility of the Contractor and the AHJ to determine fastener type and method based on static load, mounting structure and local building codes.

Recommended construction sequences, installation instructions and A&E Specifications are available in various formats on the Quam Architects' and Engineers' Resources CD or on the web at: www.quamspeakers.com

Quam-Nichols Company

234 East Marquette Road, Chicago, IL 60637
Phone: (800) NEED NOW Fax: (888) NEED NOW
(800) 633 - 3669 (888) 633 - 3669
E-Mail: neednow@qnc.com www.quamspeakers.com



07 SHELVES